



Scott Partney Construction, Inc.
598 Chappell Parkway
North Bend, OR 97459

(541) 756-7060
FX (541) 756-7067
CCB#162882

Addendum #1 – December 18, 2024

RE: **Bandon Bus Barn**
 362 9th Street SW
 Bandon, OR 97411

TO: Prospective Bidders,

This addendum modifies a part of the original Documents distributed on December 11, 2024 as noted below. Acknowledge receipt of this Addendum on your bid proposal. Failure to do so may subject Bidder to disqualification.

This addendum consists of **ONE (1)** page together with the following attachment:

- REVISED sheet C3.00: Grading, Drainage, and Utility Plan

CHANGES TO DRAWINGS:

1. Corrected keynote numbering on various callouts that were mislabeled pertaining to page C3.00: Grading, Drainage, and Utility Plan.

****THE BID TIME HAS NOT CHANGED WITH THIS ADDENDUM****

END OF ADDENDUM #1

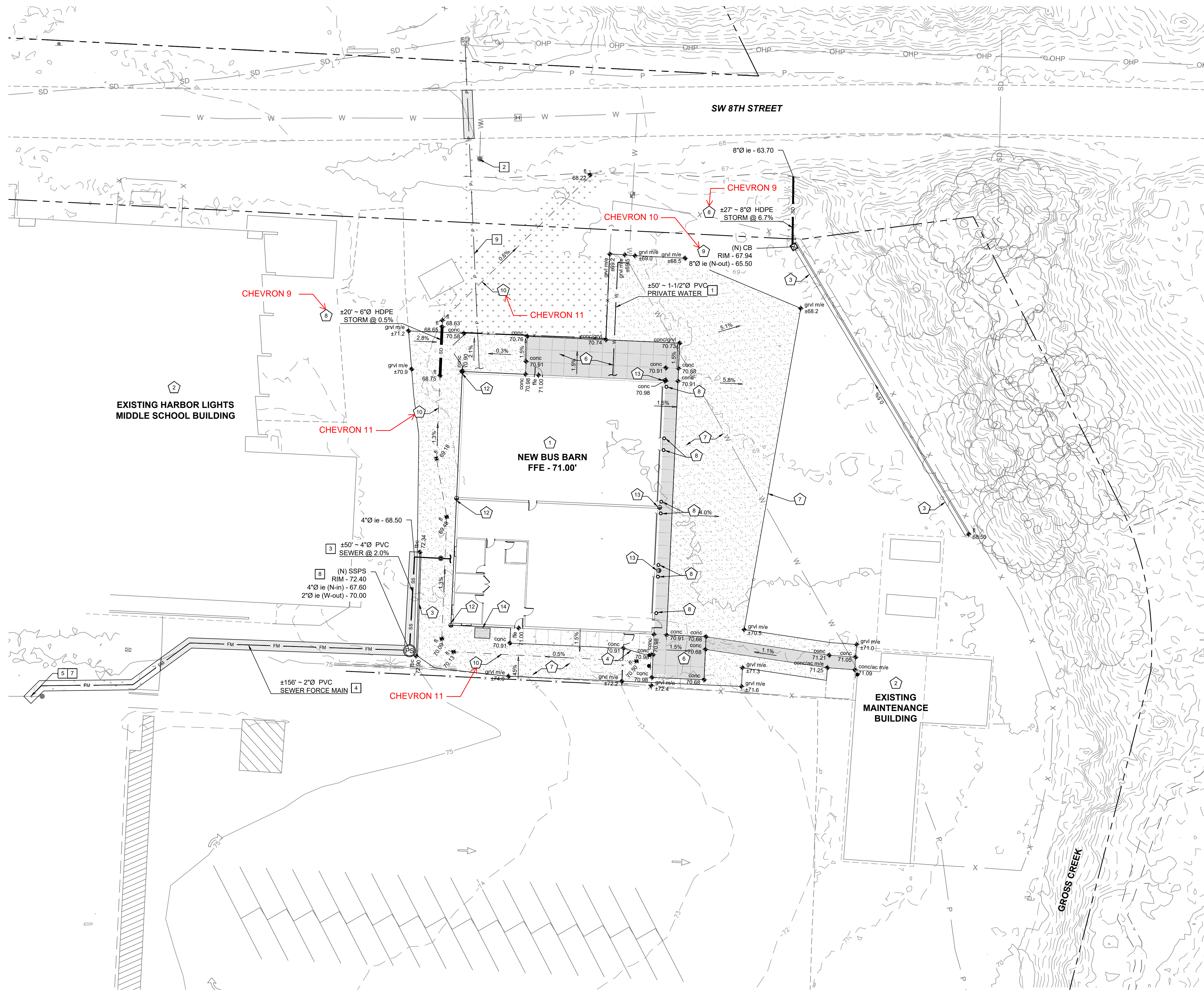

GRADING AND DRAINAGE NOTES:

GENERAL DRAINAGE NOTES:

- *** ALL STORM AREA DRAINS AND CATCH BASINS SHALL HAVE A MINIMUM 24" SUMP BELOW THE OUTLET INVERT ELEVATION AND BE EQUIPPED WITH A HOOD AND TRAP.
- *** UPON MOBILIZATION CONTRACTOR SHALL POTHOLE TO VERIFY VERTICAL AND HORIZONTAL ALIGNMENT, SIZE, AND MATERIAL OF EXISTING PIPES/STRUCTURES FOR TIE-IN PURPOSES. REPORT TO ENGINEER IN EVENT OF DISCREPANCY.
- *** PROVIDE SUBMITTALS TO ENGINEER FOR REVIEW AND APPROVAL PRIOR TO ORDERING MATERIALS.

SITE CONSTRUCTION NOTES:

1. VERIFY LIMITS OF BUILDING FOOTPRINT WITH ARCHITECTURAL AND STRUCTURAL PLANS PRIOR TO CONSTRUCTION. NOTIFY ENGINEER IN THE EVENT OF DISCREPANCIES.
2. EXISTING BUILDING. NO WORK IN THIS AREA.
3. CONSTRUCT TYPE 'A' CONCRETE CURB AND GUTTER PER DETAIL 3 ON SHEET C4.00.
4. CONSTRUCT NEW 4" THICK UN-REINFORCED CONCRETE SIDEWALK PER DETAIL 2 AND 4 ON SHEET C4.00. SCORING PATTERN APPROXIMATELY AS SHOWN.
5. NOT USED.
6. CONSTRUCT NEW 6" THICK REINFORCED CONCRETE PAVEMENT PER DETAIL 9 ON C4.00. SCORING PATTERN APPROXIMATELY AS SHOWN.
7. KEY IN NEW GRAVEL PAVEMENT SECTION. MINIMUM SECTION CONSISTS OF 8" OF 3/4" MINUS OVER EXISTING GRAVEL. MINIMUM 3" DEPTH OF REMOVAL AND REPLACEMENT OF GRAVEL PAVEMENT.
8. CONSTRUCT NEW BOLLARD IN APPROXIMATE LOCATION SHOWN PER DETAIL 10 ON SHEET C4.00. REFER TO ARCHITECTURAL PLANS FOR EXACT LOCATION. BUILDING FOUNDATION IS DESIGN BUILD. CONTRACTOR TO COORDINATE ANY CONFLICT BETWEEN BOLLARD FOOTING AND BUILDING FOUNDATION WITH STRUCTURAL ENGINEER.

DRAINAGE CONSTRUCTION NOTES:

9. INSTALL STORM PIPE IN TRENCH PER DETAIL 5 ON SHEET C4.00. STORM PIPE SHALL DRAIN TO EXISTING BIOSWALE.
10. CONSTRUCT 24" SQUARE CONCRETE CATCH BASIN WITH H-20 LOAD RATED FRAME AND BICYCLE PROOF GRATE PER DETAIL 8 ON SHEET C4.00.
11. NEW CONVEYANCE DITCH TO CONNECT TO EXISTING SWALE IN RIGHT-OF-WAY. DITCH SURFACING PER PLAN.
12. CONSTRUCT ROOF DRAIN WITH SPLASH BLOCK. VERIFY LOCATION WITH ARCHITECTURAL PLANS PRIOR TO CONSTRUCTION.
13. CONSTRUCT ROOF DRAIN TO GRADE. VERIFY LOCATION WITH ARCHITECTURAL PLANS PRIOR TO CONSTRUCTION.
14. NEW CONCRETE HOUSEKEEPING PAD PER DETAIL 9 ON SHEET C4.00.

UTILITY NOTES:

WATER

1. INSTALL 1-1/2" Ø ASTM D1785 SCHEDULE 40 PVC DOMESTIC WATER LINE FROM EXISTING WATER SERVICE TO NEW BUS BARN AT ALIGNMENT SHOWN ON PLAN IN TRENCH SIMILAR DETAIL 5 ON SHEET C4.00.
2. EXISTING FIRE HYDRANT TO REMAIN.

SANITARY SEWER

3. INSTALL NEW ASTM D3034 DR35 'PVC' GRAVITY SANITARY SEWER SERVICE WITH TRACER WIRE AND LOCATE TAPE IN TRENCH SIMILAR TO DETAIL 5 ON SHEET C4.00.
4. CONSTRUCT NEW 2" Ø ASTM D1785 SCHEDULE 40 PVC PRESSURE-RATED SANITARY SEWER GRINDER PUMP DISCHARGE LINE WITH TRACER WIRE AND LOCATE TAPE IN TRENCH SIMILAR TO DETAIL 5 ON SHEET C4.00. ENSURE NO HIGH POINTS OR LOW POINTS ARE CONSTRUCTED BETWEEN THE PUMP DISCHARGE AND THE CHECK VALVE.
5. FURNISH CLEANOUT RISER TO GRADE WITH WORD 'SEWER' CAST INTO LID PER DETAIL 7 ON SHEET C4.00.
6. CONNECT TO EXISTING 6" Ø SANITARY SEWER IN APPROXIMATE LOCATION SHOWN PER DETAIL 11 ON SHEET C4.00.
7. FURNISH NEW SANITARY SEWER PUMP STATION. DESIGN PER SUPPLIER.

POWER AND DATA/COMMUNICATIONS:

8. INSTALL PRIMARY POWER CONDUIT FROM EXISTING TRANSFORMER TO BUILDING IN TRENCH SIMILAR TO DETAIL 6 ON SHEET C4.00.



127 NW D Street, Grants Pass, Oregon 97526 | 541-479-3865

BANDON SCHOOL DISTRICT #54
455 9TH STREET SW
BANDON, OR 97411

BANDON SCHOOL DISTRICT NEW BUS BARN



REVISION ID:	DATE:

PROJECT NO: G-1533-22
DRAWN: KAK
CHECKED: LGG
DATE: 02-13-24

GRADING, DRAINAGE, AND UTILITY PLAN

C3.00

BID AND PERMIT SET

ONE INCH EQUALS FULL SCALE

1 GRADING, DRAINAGE, AND UTILITY PLAN

C3.00

1"=20'

